

HD-Q Series Motorised Ball Valve

HD-Q is a series of 2-way/3-way motorised ball valves intended for use in heating and cooling system. Suitable for hot and chilled water.

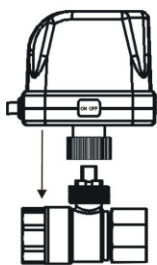

Connection Diagram



Press the driver into groove

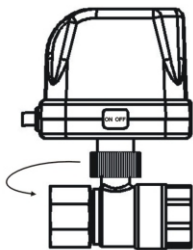

Fasten the nut as above diagram

Features

- Smooth flow, no clog.
- High flow capacity,3 times flow rate more than traditional zone valve.
- Suitable for any specifications of fan coil unit.
- Tight close, no leakage.
- The power is cut off when the valve reaches the on/off position. This ensures long life service for the actuator.
- The actuator cover adopts close structure which is resistive to humidity and ensures reliable operation for motor.

Models

- HD-Q15 2-way, DN15(15mm)
- HD-Q20 2-way, DN20(20mm)
- HD-Q25 2-way, DN25(25mm)
- HD-Q20-3 3-way, DN20(20mm)
- HD-Q25-3 3-way, DN25(25mm)

Technical Datas

- Medium..... Water, 60% glycol
- Valve Type.....2-way/3 way
- Working mode..... 24VAC or On/Off
- Supply Voltage.....220VAC,24VAC
- Power.....6W
- Working time.....5~15 seconds
- Pressure.....1.6MPa
- Max.Pressure differ.....1.0MPa
- Fluid temperature.....2℃~95℃
- Valve body.....Bronze
- Protection Class.....IP65

Wiring Diagram

